

*Courses & distances*

*Begin at end of 4<sup>th</sup> line*

- 5. N 64 W 33.
- 6. West 13 $\frac{1}{2}$
- 7. S 65 W 30 Ch<sup>t</sup>
- thence Up division*
- 8. S 43 E. 60 $\frac{1}{2}$  Stones
- 9. S 71 $\frac{1}{2}$  W 29 $\frac{1}{2}$  Stones
- 10. S. 7 E 52 Stones
- 11. S. 65 W 8 $\frac{1}{4}$  Stones
- 12. S. 5 E. 31. Stones
- 13 N 75 E. 7 $\frac{1}{3}$  Stones
- 14. S. 6. E. 3 $\frac{3}{4}$  Post

*Beginning*

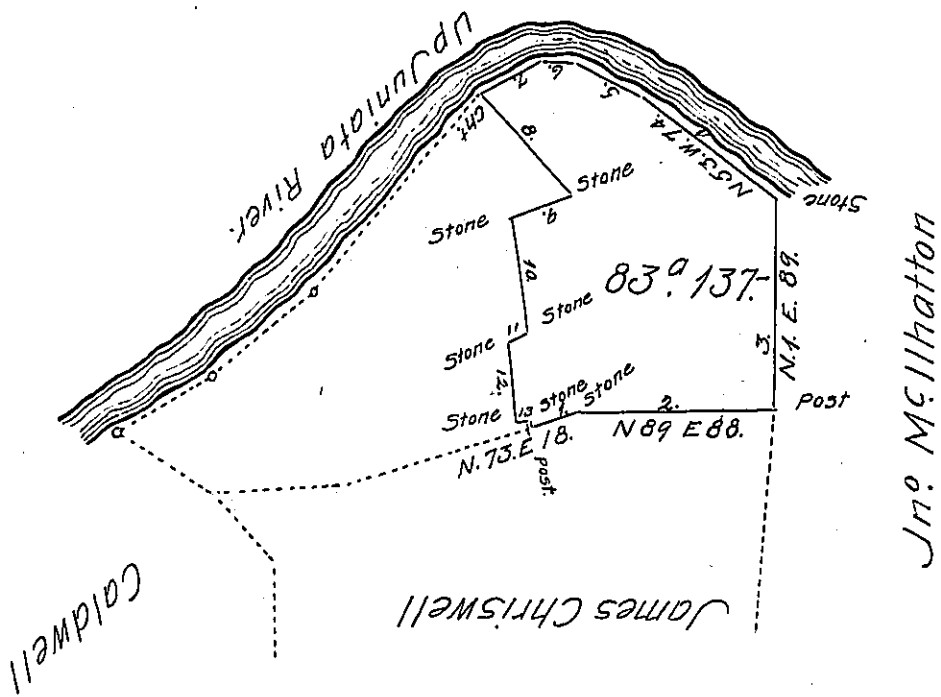

*A Draught of eighty three acres and one hundred and thirty seven perches of land with 6 Pr Cent for Roads situate in Wayne township in Mifflin county (formerly Cumberland) which is part of a tract of land surveyed in pursuance of a Warrant to James Chriswell dated 13<sup>th</sup> July 1762 said to contain 165 acres. Resurveyed and divided 10<sup>th</sup> and 11<sup>th</sup> February AD. 1814. and found to contain 174 acres & 68 perches with 6 Pr Cent*

*To Richard T. Leech Esquire } Michael M. Monahan  
Surveyor General of Pennsylvania }*

*IN TESTIMONY that the above is a copy of the original remaining on file in the Department of Internal Affairs of Pennsylvania, made conformably to an Act of Assembly approved the 16th day of February, 1833, I have hereunto set my Hand and caused the Seal of said Department to be affixed at Harrisburg, this twenty fourth day of May 1904.*

*Loac R. Brown*  
Secretary of Internal Affairs.